



The pumps listed on this data sheet represent a cross-section of the large number of possibilities for each pump type. Based on our modular pump design, all pumps can be customised exactly to meet the needs of your application - within days and at standard pricing. Please contact us for details.



SP 600 EC
iron core motor
with ball bearings



SP 600 EC-LC
iron core motor
with sintered bearings

Product Features

- Vacuum or pressure optimised design
- High efficiency and durable design
- Small size and low weight
- Low vibration and sound level
- Suitable for any mounting orientation
- Oil-free, maintenance-free, leak-tight

Typical Applications

- Exhaust and flue gas analysis
- Auto samplers
- Blood pressure monitoring
- Chromatography
- Dental vacuum
- Gas analysis
- Anaesthesia monitoring



TYPE	SP 600 EC		SP 600 EC-LC	
Operating Voltage [Vdc]	12	24	12	24
Art. No.	7s52115	7s52116	7s52100	7s52101
max. Nominal Current [mA]	360	180	390	195
PERFORMANCE				
max. Flow [l/min]	3,0	3,0	2,8	2,8
max. Pressure [bar]	1,3	1,3	1,35	1,35
max. Vacuum [mbar]	-550	-550	-560	-560
MOTOR				
Standard Motor	iron core		iron core	
Standard Bearings	ball bearings		sintered bearings	
Motor Connection	2 wires	soldering lugs	soldering lugs	
Optional Motor	n/a		n/a	
Optional Bearings	sintered bearings		n/a	
MATERIALS				
Standard Pump Head	PPS			
Optional Pump Head	customer specific (upon request)			
Standard Diaphragm	EPDM			
Optional Diaphragm	FKM / FFKM / PTFE			
Standard Valves	EPDM			
Optional Valves	FKM / FFKM / customer specific (upon request)			
Standard Gaskets	EPDM			
Optional Gaskets	FKM / FFKM / customer specific (upon request)			
PNEUMATIC CONNECTION				
Standard Connectors	barbed connectors			
Optional Connectors	n/a			
DIMENSIONS + WEIGHT				
Dimensions [mm] W x H x L	31 x 54 x 81,5		31 x 54 x 76	
Weight [g]	184		165	

Flow values are subject to the standard conditions specified in DIN 1343. The use of other materials may cause deviations in performance values.

The technical data shown on this data sheet represents the typical mean values achieved by the products in our standard testing procedure.

All data provided is for information only and does not represent production values.

Standard products are subject to change without notice.

12.06.2021



SP 600 EC

PERFORMANCE DIAGRAM | SP 600 EC - SP 600 EC-LC

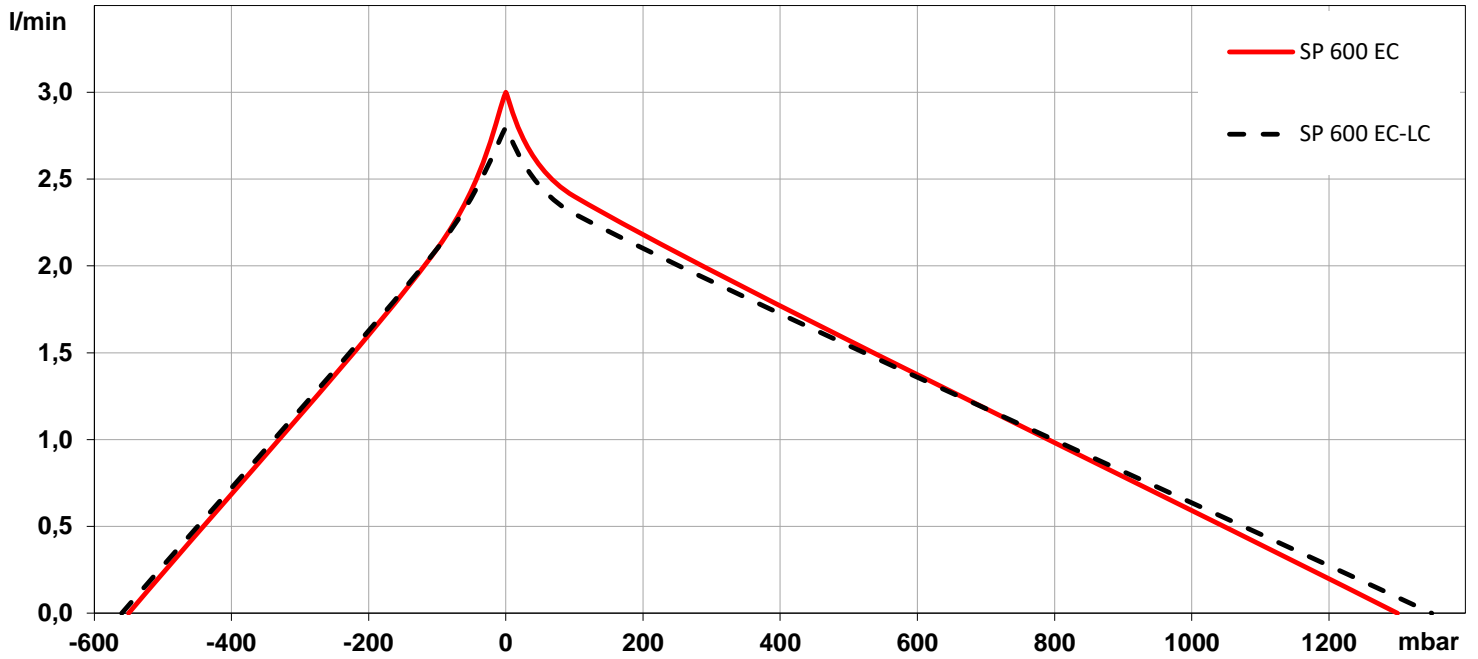

DRAWING | SP 600 EC

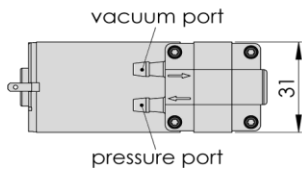
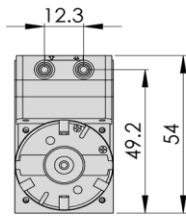
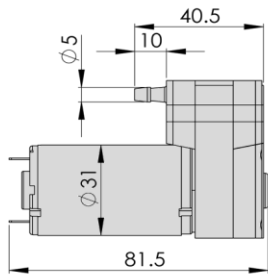

3D CAD Data:

- ▶ Download STEP
- ▶ Download IGES

DRAWING | SP 600 EC-LC

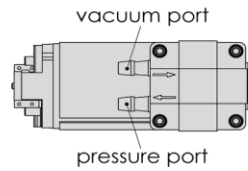
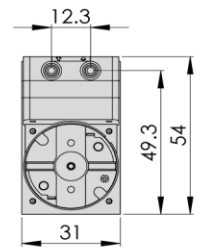
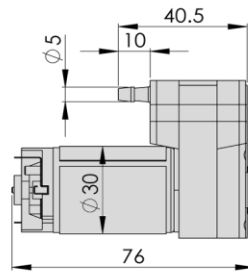

3D CAD Data:

- ▶ Download STEP
- ▶ Download IGES

Drawing shows standard orientation of pneumatic connectors (3 alternative orientations possible).

You can also download the 3D CAD files from the SP website: [▶ www.schwarzer.com/download](http://www.schwarzer.com/download)

All data provided is for information only and does not represent production values.

Standard products are subject to change without notice.

12.06.2021